

SUBDIVISION PLAT OF Live Oak Creek Ranch

H. & T.C. R.R. Co.
Sur. 75
A-419

Rudloff Family Partnership, Ltd.
"Tract No. One", called 430.52 acres
Vol. 197, Pg. 770
Official Public Records
Concho County, Texas

Rebecca Sue Sorrell Lueddecke
"Tract No. Two", called 173.07 acres
Vol. 149, Pg. 663
Deed Records
Concho County, Texas

LEGEND

- Iron Stake set with cap marked "6163"
- Iron Stake found, as noted
- ⊕ 2" diam. iron pipe found
- ⊙ Set 8" spike with washer stamped "Little 6163"
- Fence post found, as noted
- Overhead Power Line
- Patent survey lines
- ⊗ Water well

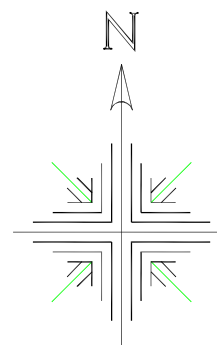

SCALE 1"=300'

Basis of Bearings

Being derived from GPS observations in the Texas State Plane Coordinate System, NAD 1983 Texas Central Zone, made on July 29, 2014.

Surveyor's Note: No Survey was made to reestablish Patent Survey Lines and or Corners. Those shown hereon are approximate, unless otherwise noted.

Note: All visible and/or apparent encroachments and easements that were located on the ground have been shown on this plat. Always use the Texas One Call System or www.texas811.org, before performing any excavations.

Certification Note: Original Copies have inked seal with the signature in blue ink and have an embossed seal overlapping the inked seal, signature & certification.

M. Hughes
Sur. 76
A-1804

Steven M. Norman
"Tract Four",
called 168.59 acres
Vol. 167, Pg. 21
Official Public Records
Menard County, Texas

J.F. Smith
Sur. 1
A-1615

Steven M. Norman
"Tract Three",
called 306.94 acres
Vol. 167, Pg. 21
Official Public Records
Menard County, Texas

M. Hughes
Sur. 114
A-1847

NOTE: Tracts 1, 2, 34, and 39 each have a 1/8th ownership interest in the water well located between Tracts 34 and 39. Developer retains a 1/8th ownership interest to itself, its successors, or assigns.

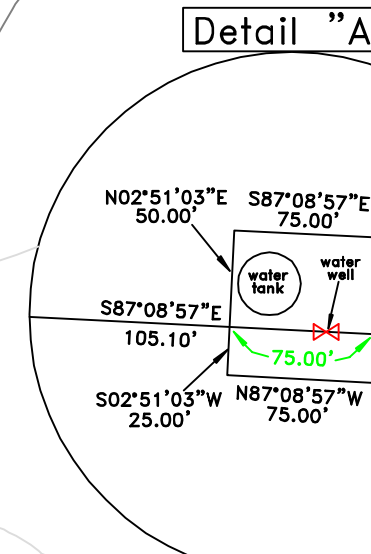

1/3 WELL

D. Miller
Sur. 2
A-1755

Timber Trail Tree Farm
called "637.7 acres"
Vol. 211, Pg. 448
Official Public Records
Concho County, Texas

